

EL-SID "Static Impeller Driver" Electronic, Low Voltage & PV Powered Pump

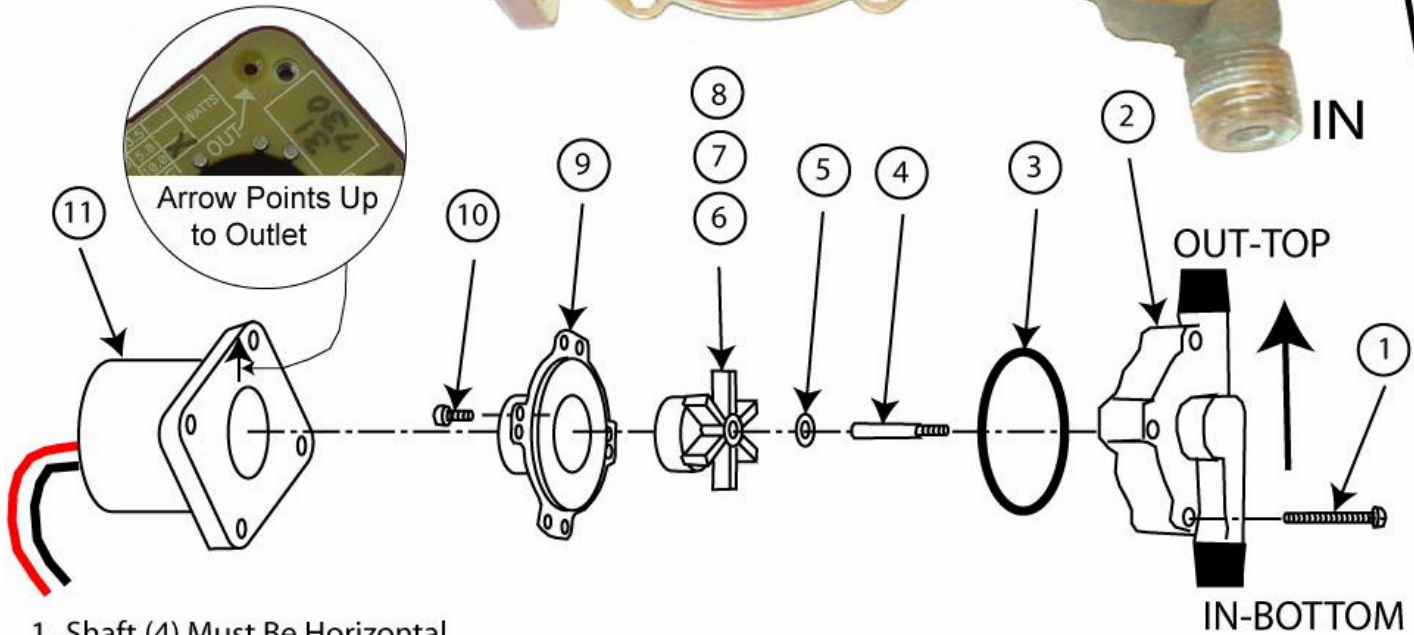

1. Shaft (4) Must Be Horizontal
2. Outlet Arrow Must Point Up To Outlet

2. Four Tell-Tale LED's

Off-Off	Off-Off	No Power
On-Off	On-Off	Trying to Start
On<>Off	Off<>On	Almost Starting
On-On	On-On	Spinning

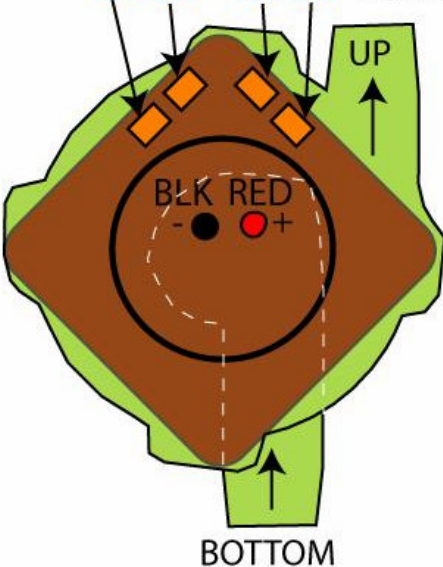

Solar Pump, EL-SID Impeller Driver

Maximum Liquid Temp:	250° F
EL-SID - 10 Impeller Driver:	1,800 RPM
Max. Head:	3.5 Feet Into an air column
Construction:	Bronze, Stainless Steel, Ryton
Dimensions:	4-7/8 " Tall "Inlet to Outlet"
	3" Wide
	3.5" Deep With EL-SID -10

REPAIR PARTS LIST

ITEM	DESCRIPTION	QTY.	PART NO.
1	#8 x 1-1/4 Rd. Hd. Screw	4	0923-0003-1000
2	Pump Housing W/1/2 MPT	1	0809-0013-0000
3	"O" Ring, Silicone Rubber, bronz housing	1	0809-0165-1000
4	Impeller Shaft w/Thread	1	0809-0008-1000
5	Thrust Washer	1	0809-0043-1000
7	Impeller & Magnet: 2" Dia. (1600 RPM) 809	1	0809-0005-0100
9	Impeller Magnet Housing	1	0809-0012-1000
10	#8 x 3/8 Long Rd. Hd. Screw	4	0135-0040-1000
11	EL-SID-10 Static Impeller Driver	1	Ivan Labs Part.

IVAN LABS, Inc., 305 Circle West, Jupiter, FL 33458, USA, Voice: (561) 747-5354, Fax: (561) 746-9760, ivandelsol@bellsouth.net